

MD-S200 INTELLIGENT DIGITAL PRESSURE GAUGE

TECHNICAL CHARACTERISTICS:

- ✓ 5 digit LCD showing the pressure accurately in real time
- ✓ Different pressure units available, zero clearing, backlight, on/off
- ✓ Battery-powered, low-power design keeping working for 12 months
- ✓ High precision, long-term stability



This gauge is a high-precision and intelligent digital pressure gauge. It has a high-precision sensor and display the pressure accurately in real time, equipped with a large size LCD. It has a various of features, such as zero clearing, backlight, on/off button, units, low voltage alarm. And it is convenient to install and easy to operate. This gauge can be used as peak record to record the maximum and minimum.

The surface and connector of the product is 304SS. It can be used to measure gas, liquid, oil and other non-corrosive mediums of stainless steel. It applies to these fields: portable pressure measurement, equipment supporting, equipment calibrations.

APPLICATION:

- ◇ Machinery and electronic industry
- ◇ Supporting equipment of instruments and meters
- ◇ Pressure Laboratory
- ◇ Mechanical engineering automation
- ◇ Replacement of pointer precise pressure gauge

SPECIFICATION:

Range	0~10...25...50...100kpa -1~2...6...10...16...40...60...100...250...400...600Bar
Over Pressure	150% ;
Backlight Color	White
Dial Size	MD-S200 (100mm)
Acc.	0.2%FS(Special Customized) 0.4%FS
Long-term Stability	Typical: ± 0.2%FS/year
Operating Temperature	-10 ~ 60°C
Compensation Temperature	18 ~ 30°C
Electric Protection	EN61326
Sampling Frequency	5Times/sec
Measurement Medium	Gas, water, oil
Pressure Connection	M20*1.5 or screw customized
Connector Material	304SS
Shell	Stainless steel
Product Features	On/off, backlight, zero clearing, units changing, calibration
Supply	Battery
Battery Model	MD-S200(triple AA battery)





SIZE:

Unit:mm

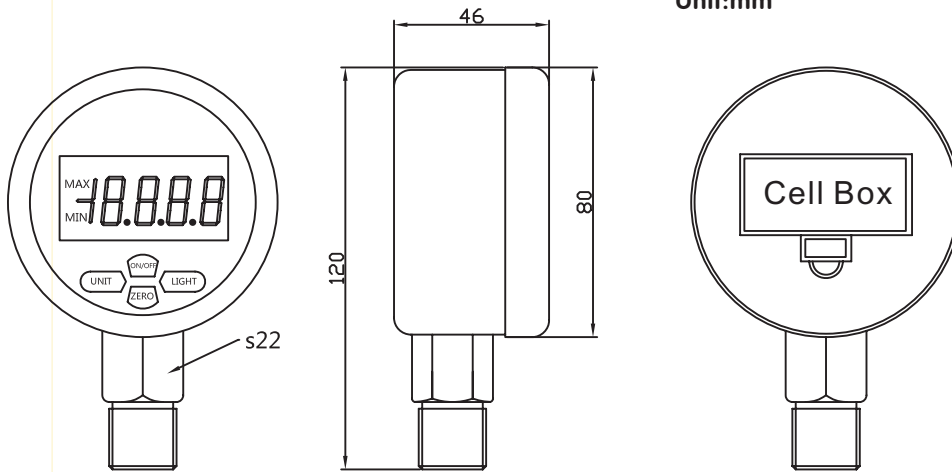

MD-S280 INTELLIGENT PRESSURE GAUGE(Dial Diameter 80mm)

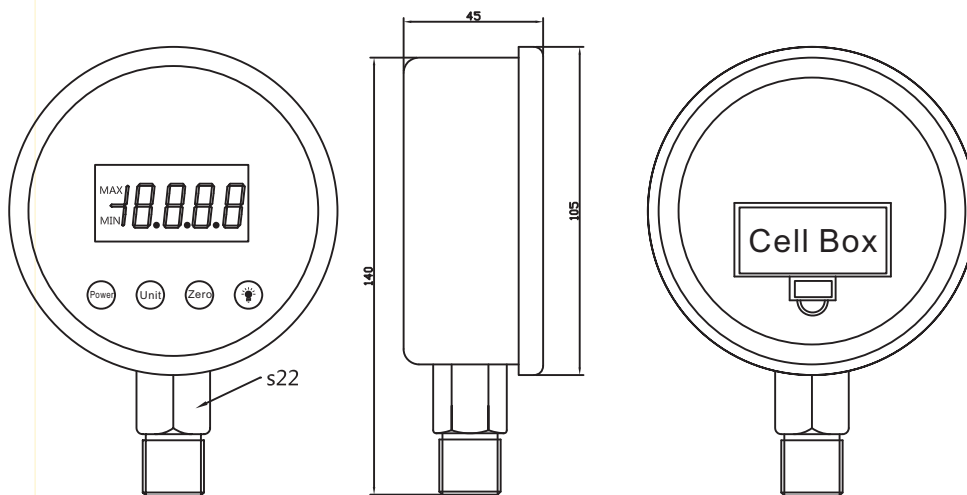

MD-S200 INTELLIGENT PRESSURE GAUGE (Dial Diameter100mm)

SELECTION TABLE:

Model	Dial Diameter	Range	Screw Connector	Acc.	Shell	Weight (kg)
MD-S200	100mm	(- 0.1)...0.1...0.6...1.0...1.6...2.5...4 .0...6.0...10...16 ...25...40...60M	M20*1.5	0.40%	Stainless Steel	0.35
			G1/4			
MD-S280	80mm	PA	Screw Customized			Stainless Steel

